

WEAVER®

Safety Lane

WJ-27A Alignment Tester

Parts Manual

For Parts, Please Contact

Castle EQUIPMENT
COMPANY
SINCE 1950

TOLL-FREE: 888-274-8490
TELEPHONE: 815-458-6216
FAX: 815-458-9350
E-MAIL: CASTLE@AMERITECH.NET
WEBSITE: WWW.CASTLEEQUIPMENT.COM
P.O. Box 3; BRAIDWOOD, IL 60408

REPAIR PARTS LIST
WJ-27A WHEEL ALIGNMENT INDICATOR

ORDER ALL PARTS BY PART NUMBER

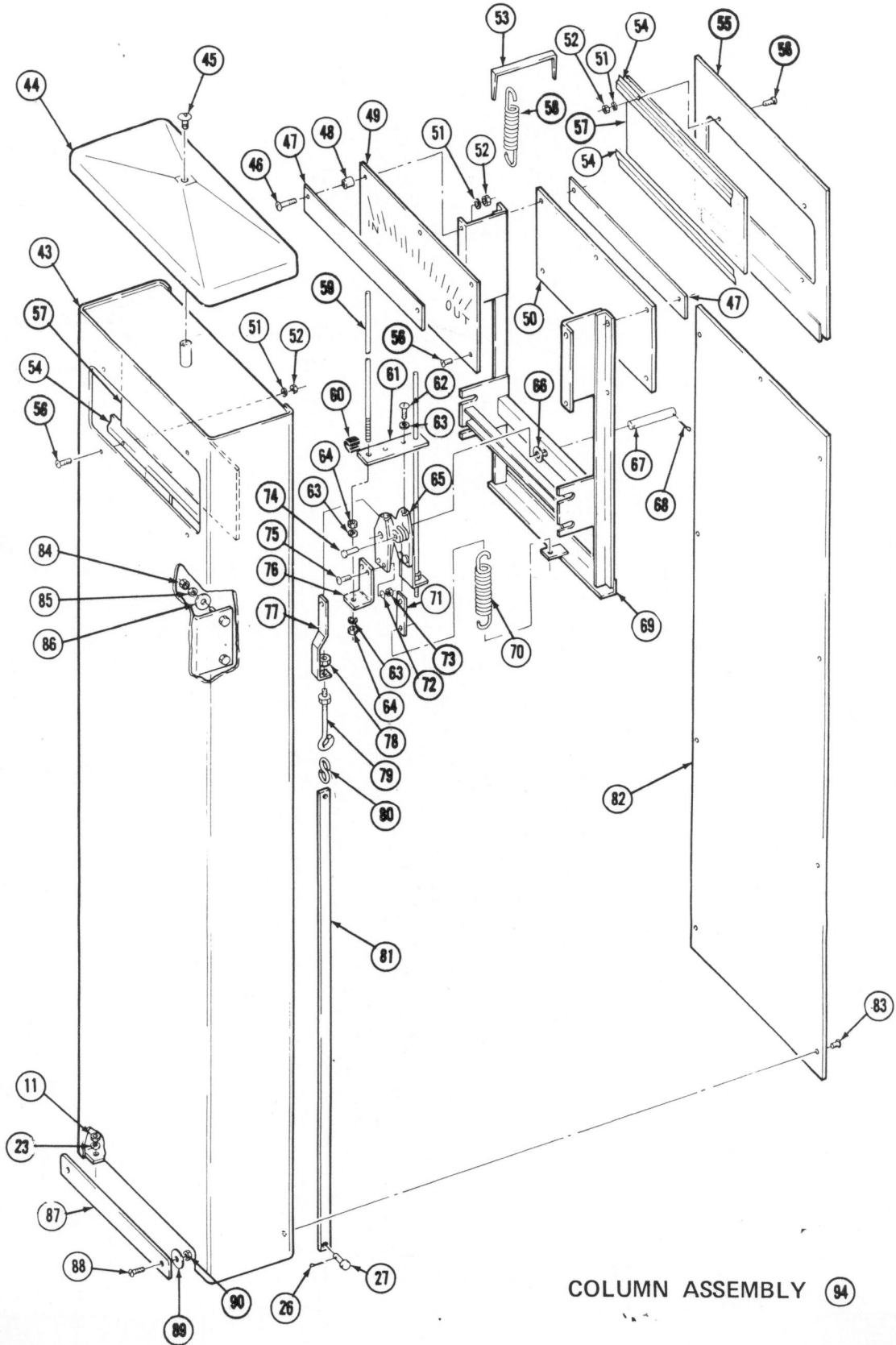

WHEEL
ALIGNMENT

COLUMN ASSEMBLY (94)

REPAIR PARTS LIST
WJ-27A WHEEL ALIGNMENT INDICATOR
ORDER ALL PARTS BY NUMBER

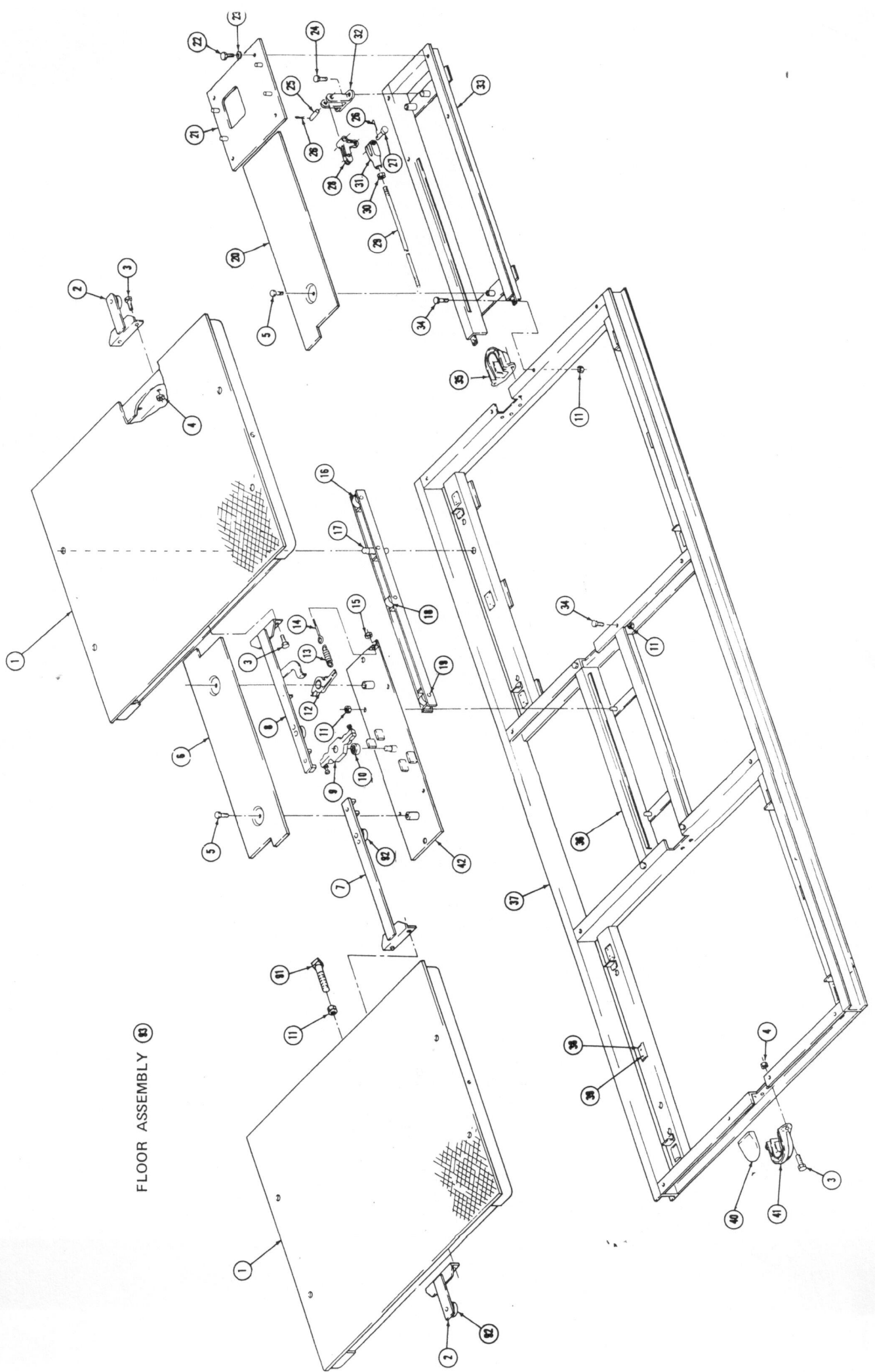

FLOOR ASSEMBLY (1)

ITEM NO.	PART NO.	QTY	DESCRIPTION	ITEM NO.	PART NO.	QTY	DESCRIPTION
1	AS-9346	2	Wheel Plate Assembly	48	S-19402	6	Spacer
2	AS-5085	2	Short Parallel Bar (Includes Item 92)	49	S-24450	1	Front Dial Bottom Plate
* 3	S-7403	12	Hex Hd. Capscrew 1/2-13 x 1 1/4	50	S-24451	1	Rear Dial Bottom Plate
* 4	S-508	16	Hex Nut 1/2-13	* 51	S-8705	18	Internal Lockwasher
* 5	S-5786	3	Hex Hd. Capscrew 1/2-13 x 3/4	* 52	S-21098	18	Hex Nut No. 6-32
6	S-5077	1	Center Cover Plate	53	S-23076	2	Safety Limit Marker
7	AS-5084	1	Parallel Bar Assy. (Includes Item 92)	54	S-22431	4	Plexiglass Retainer
8	AS-5070	1	Return Parallel Bar (Includes Item 92)	55	AS-22458	1	Top Back Panel
9	AS-20715	1	Parallel Bar Link Assy. (Includes Item 10)	* 56	S-21105	12	Rd. Hd. Mach. Screw No. 6-32 x 3/8
10	S-6777	1	Ball Bearing	57	S-22397	2	Dial Window
* 11	S-595	26	Hex Nut 3/8-16	58	S-12044	2	Extension Spring
12	M-1141	1	Center Lever	59	S-19947	2	Pointer
13	S-4716	1	Centering Spring	60	S-19952	2	Pointer Bumper
14	S-21015	1	Eye Bolt	61	S-22403	1	Pointer Support
* 15	S-4764	1	Adjusting Nut	* 62	S-6022	2	Rd. Hd. Mach. Screw No. 10-24 x 1/2
16	AS-27692	4	Roller Retainer Assy. (Include Items 17, 18 & 19)	63	S-8872	4	Internal Lockwasher
17	S-5091	4	Roller Retainer Operator	* 64	S-7483	4	Hex Nut No. 10-32
18	S-5093	12	Plate Roller	65	M-2231	1	Pivot Bracket
19	S-5087	16	Pin 3/8 Dia. x 2 1/4	* 66	S-20109	2	Washer 11/32 I.D.
20	S-25317	1	Column Frame Cover Plate	67	S-4777	1	Pin
21	AS-25320	1	Column Base Plate	* 68	S-107	1	Cotter Pin 1/8 Dia. x 1
* 22	S-6652	4	Hex Hd. Capscrew 3/8-16 x 7/8	69	AS-22410	1	Indicator Frame
* 23	S-1325	16	Lockwasher 3/8	70	S-19630	1	Pointer Return Spring
* 24	S-722	2	Hex Hd. Capscrew 1/2-13 x 1	71	S-4737	1	Hand Bracket Spring Coupling
25	S-4776	1	Pin 5/16 Dia. x 2 5/16	* 72	S-14430	4	Internal Lockwasher
* 26	S-4074	4	Cotter 1/16 Dia. x 3/4	* 73	S-22448	4	Hex Nut No. 8-32
27	S-4632	2	Pin 3/8 Dia. x 29/32	* 74	S-4795	2	Rivet No. 30 x 10/16
28	M-1564	1	Bellcrank	* 75	S-22449	4	Rd. Hd. Mach. Screw No. 8-32 x 1/2
29	S-23735	1	Push Rod	76	S-22402	2	Pointer Bracket
* 30	S-21825	1	Hex Nut 5/16-24	77	S-4738	1	Hand Bracket Coupling
31	S-6303	1	Clevis	* 78	S-20321	2	Elastic Stop Nut No. 10-24
32	M-1139	1	Bracket	79	S-21015	1	Eye Bolt
33	AS-24005	1	Column Frame Assy.	80	S-23074	1	S-Hook
* 34	S-105	10	Hex Hd. Capscrew 3/8-16 x 1	81	S-22475	1	Vertical Link
35	M-1169	1	Inner Roller Guide	82	S-22379	1	Bottom Back Panel
36	AS-6237	1	Center Frame Assy.	* 83	S-22472	13	Truss Hd. Screw No. 8-32 x 3/8
37	AS-9344	1	Frame Assy.	* 84	S-21268	4	Hex Nut 1/4-20
38	S-3667	24	Wheel Plate Roller Race	* 85	S-21588	4	Lockwasher 1/4
* 39	S-4183	48	Screw 5/16-18 x 9/16	* 86	S-21318	4	Flatwasher 9/32 I.D.
40	1170	1	Roller Guide Cap	87	S-21463	1	Column Filler Strip
41	M-1168	1	Outer Roller Guide	* 88	S-18600	2	Rd. Hd. Mach. Screw No. 10-32 x 1/2
42	AS-8717	1	Center Plate Assy.	* 89	S-21095	2	Washer
43	AS-22452	1	Column Shell	* 90	S-7483	2	Hex Nut No. 10-32
44	S-22398	1	Column Cap	91	S-11109	4	Sq. Hd. Bolt 1/2-13 x 3
* 45	S-22474	1	Truss Hd. Machine Screw 1/4-20	92	S-5092	4	Guide Roller
* 46	S-22446	6	Rd. Hd. Machine Screw No. 6-32 x 7/8	93	AS-25322		Complete Floor Assembly
47	S-19405	2	Dial Top Plate	94	AS-23768		Complete Column Assembly

NOTE

Item Numbers With An Asterisk (*) Indicates Standard Hardware and Can Be Purchased Locally

WEAVER PARIS DIVISION (606)987-2240
DURA CORPORATION FORDS MILL ROAD PARIS, KENTUCKY 40361 **K**
 Kilde

TIRE SCUFF INDICATOR

AS-25370

ITEM PART NUMBER QTY D.S. DESCRIPTION

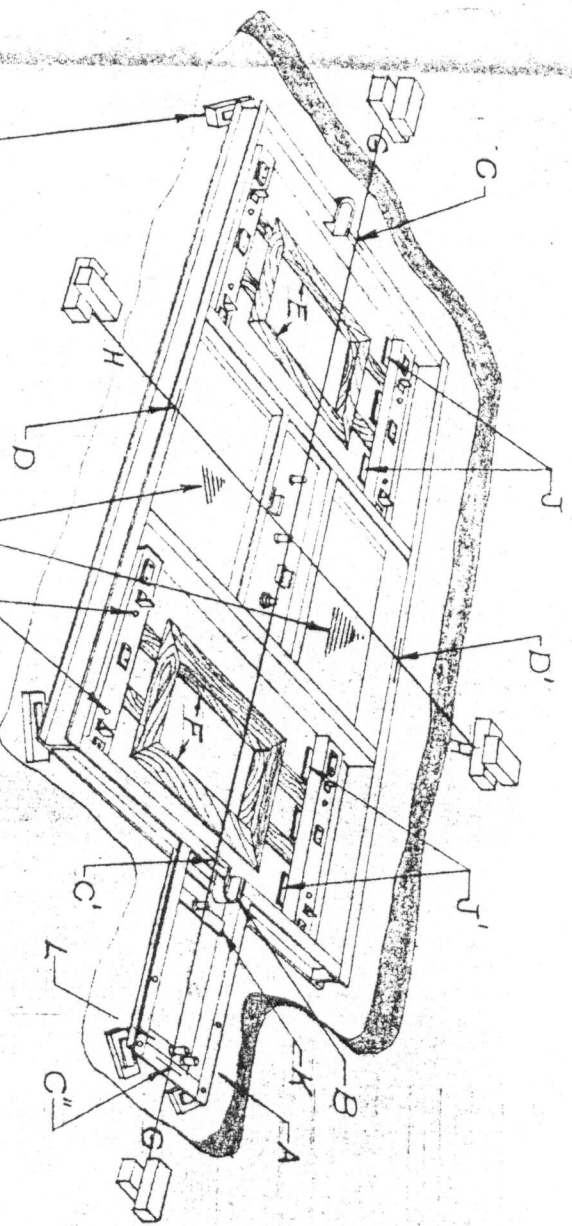

STEEL, CONCRETE, ETC. FOR FRAME LEVELING
R TYP. PLACES
"X" "X" "X" "X"

NOTE:
1. CENTERLINE D-D' TO BE PARALLEL WITH AND IN THE CENTER OF THE NORMAL TRAFFIC FLOW.
2. ALL SURROUNDING CONCRETE TO BE INSTALLED WITH ADEQUATE EXPANSION MEANS TO PREVENT EXCESSIVE STRESS ON THE EQUIPMENT.

BREAK OUT FLOOR WITH AMPLE ROOM FOR FRAME (SEE AS-25369).
BOLT EXTENSION "A" TO THE SIDE HAVING A HOLE IN CASTING "B".
MARK CENTER ON FRAME AT C, C', G' AND D, D' STRETCH LINE G, G' AND H, H' TO LINE FRAME WITH TRAFFIC FLOW AND FLOOR.
IT IS DESIRABLE TO HAVE THE FRAME LEVEL BUT A SLOPE OF ONE INCH IN LENGTH AND 1/2 INCH IN WIDTH IS PERMISSIBLE.
PLACE FORMS "E" AND "F" IN EACH FRAME PLUG HOLES "R" TO PREVENT ENTRANCE OF CONCRETE.
POUR CONCRETE WHERE SHOWN IN AS-25369 LEVEL WITH SUPPORTS "J" AND TIE PLATES "X" AND "L".
CARE MUST BE TAKEN TO INSURE THE CONCRETE WILL BE WELL RUDDED AROUND AND UNDER ALL MEMBERS.
FINISH AREAS "X" LEVEL WITH FRAME FAIR CONCRETE ALL AROUND FROM FRAME TO EXISTING FLOOR.

QTY	MACH	GEN'L. FLOOR ASSYS.	AS-25322
	MACHINE	ASSEMBLY NAME	ASSY. NO.

WEIGHT	TOLERANCE UNLESS OTHERWISE SPECIFIED	MATERIAL	DATE	ON BY
LB	± 100	PART	9/29/70	KCM
LB	± 050	INSTALLATION INSTRUCTION		
LB	± 020			
LB	± 005			

LTR. CHG. NO. DATE CK. BY
WEAVER DIVISION
WALTER KIDDE & COMPANY, INC.
PO BOX 138 LEBANON, OHIO 45031

AS-25370